

USER MANUAL

SOAPTAP

Wall mounted

Prod. no. 378/382/478/482

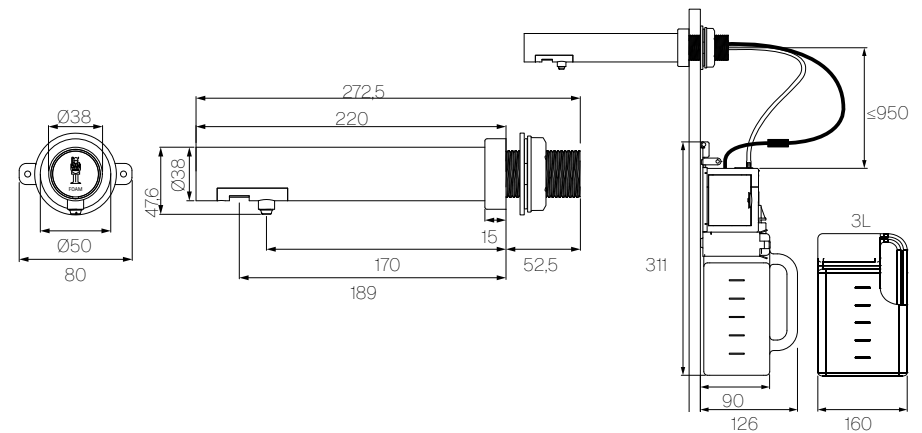

TABLE OF CONTENTS

Dimensions and technical specifications	3
General safety information	4
Installation	5
Installation height	8
Product application	8
Light indicator	8
Cleaning and maintenance	9
Refill of soap reservoir	9
Timer settings	10
Troubleshooting and corrective actions	11
Parts list	12
Spare parts list	

DIMENSIONS AND TECHNICAL SPECIFICATIONS

Dimensions Unit of measurement: mm



IMPORTANT!

This product falls within the scope of the WEEE directive on recycling and recovery of waste electrical and electronic equipment.



- This product should not be disposed of with general household waste
- This product must be reused if possible
- Contact your local authority for further details
- This product may also be returned to the manufacturer/retailer for proper treatment, recovery and recycling

TECHNICAL SPECIFICATIONS

DESCRIPTION	DATA
Material	Stainless steel - AISI 304
Voltage	6V DC, AC/DC adapter is included
Stand-by power	0.3-0.4W
Sensor type	Infrared, self adjusting
Sensor range	20 mm - 150 mm. Standard 120 mm ± 20 mm, adjustable.
Soap/foam dosing volume	1-1.5 ml (soap), 0.6-0.8 ml (foam)
Soap pump service life	100,000 activations
Mechanism service life	500,000 activations
Soap container	1,500 ml, optional 3000 ml
IP Class	IP35
Net weight	1.9 kg
Gross weight	2.3 kg
Models	378, Stainless steel, satin finish 382, Stainless steel, satin finish 478, Stainless steel, black PVD coating 482, Stainless steel, black PVD coating



GENERAL SAFETY INFORMATION

WARNING

- Turn off the power to the unit before servicing or cleaning
- Never modify the product
- Never insert objects into any opening in the product
- The product is not intended for playing purposes
- Cleaning and user maintenance must not be carried out by children
- The product may only be used for the applications described in this manual
- Do not use any accessories not recommended by the manufacturer
- The product should be checked on a regular basis. Never use a defective or malfunctioning unit
- Never make alterations to the product affecting its performance. DAN DRYER's product warranty does not cover product problems that result from misuse or alteration

NOTE

If the power supply cord is damaged, it must be replaced immediately. Disconnect the electricity supply cord according to instructions.

This product is not intended for use by persons (inclusive children) with reduced physical, sensory or mental capabilities, or lack of experience and knowledge, unless they are supervised or have been given instruction concerning use of the product by a person responsible for their safety.

Children should be supervised to ensure this product is used correctly.

INSTALLATION

- Make sure the main breaker is turned off. Installation must be carried out by a qualified person in accordance with applicable standards in the country concerned.

1a. Check the required distance from sensor to sink.

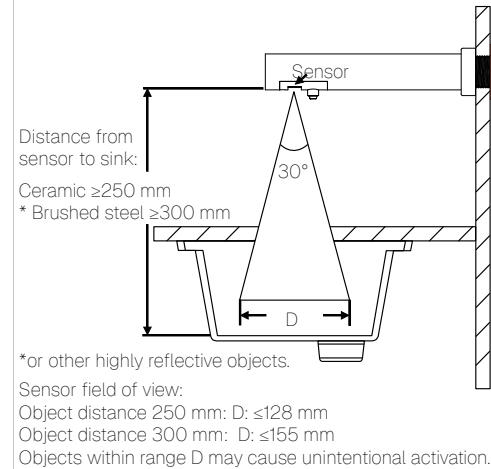

1b. Check the required distance from sensor to sink.

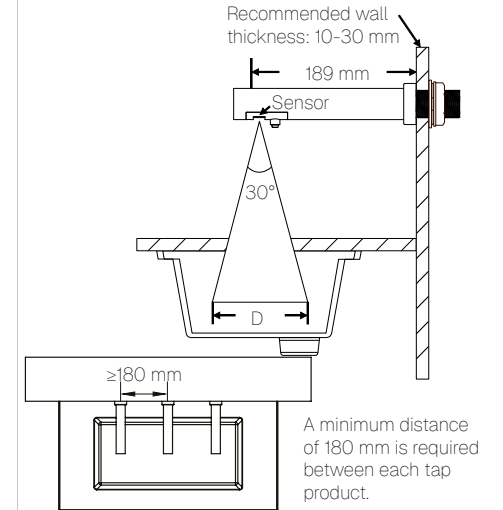

2. Mark the desired position on the wall and drill a Ø35 mm diameter hole.

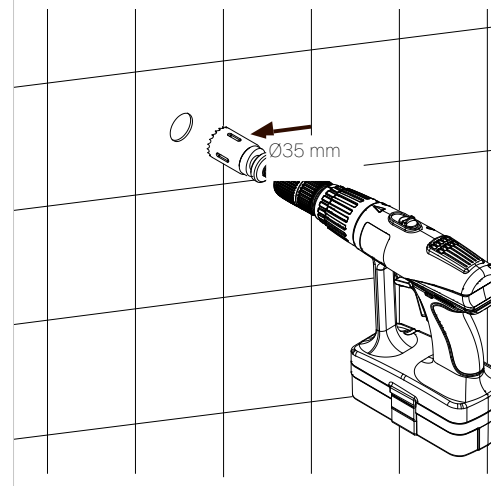

3. Installation of the tap:

- Push the screwed bushing through the hole in the wall
- Place gasket, disc, and nut on the threaded coupling of the tap
- Tighten with tool, be careful not to overtighten the nut

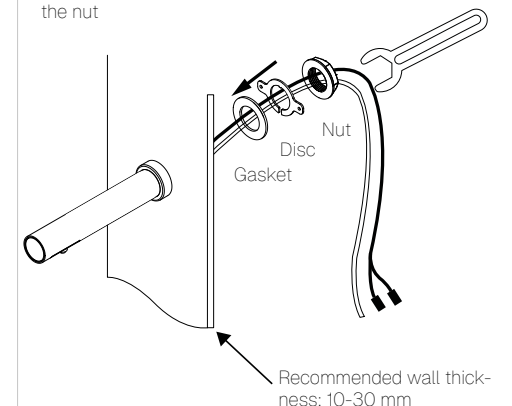

INSTALLATION

4. Use a template to drill the holes for the bracket. Install bracket close to Soap/Foam Tap; behind a wall, in a cabinet, or under the sink.

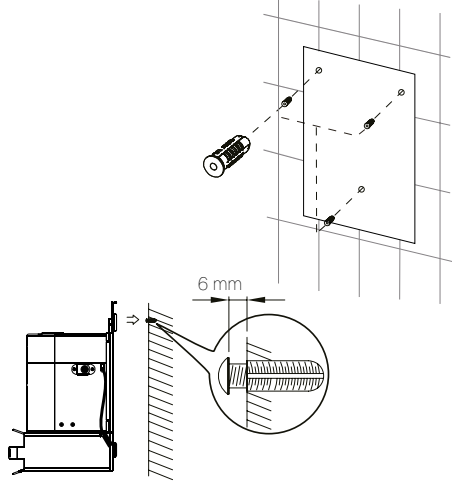

5. Fasten bracket into the pre-drilled holes.

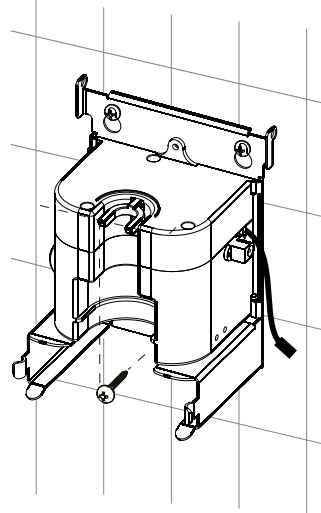

6. Connect the soft rubber tube to the outlet of the pump, and place the pump into the soap container.

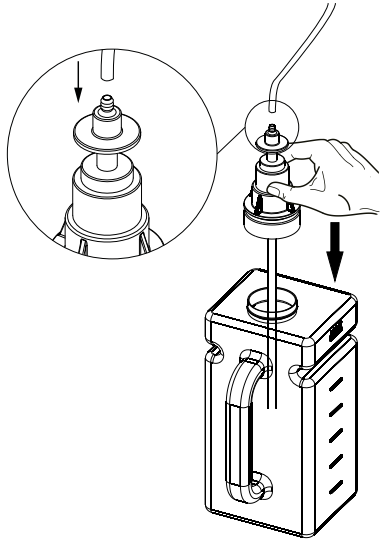

7. Connect the tube to the pump and the cables to the control box.

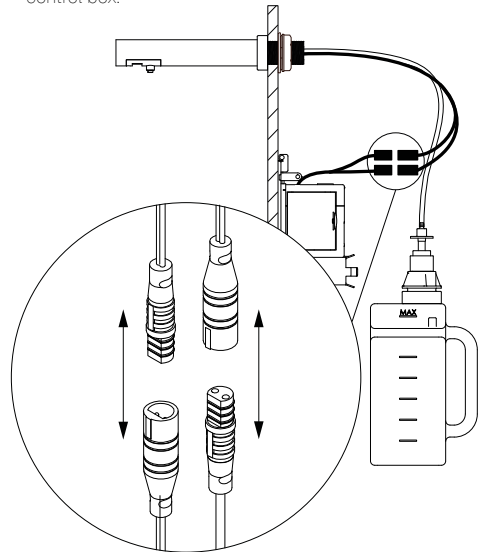

INSTALLATION

8. Insert soap container 1.5 or 3 L. Confirm the container is placed correctly to activate the dispenser. The fork should be on top of the disc at the pump top.

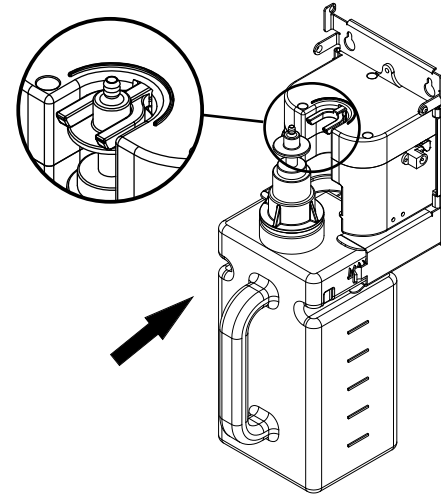

9. Connect 6 V DC power supply to control box.

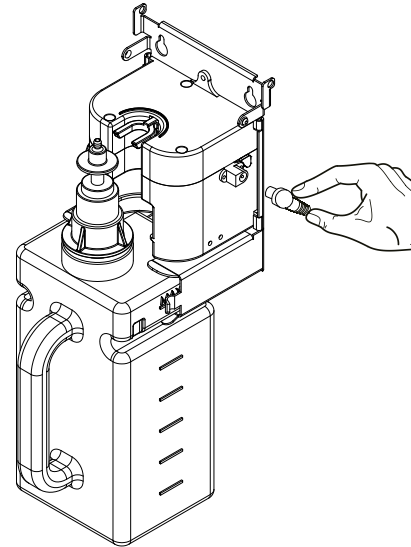

INSTALLATION HEIGHT

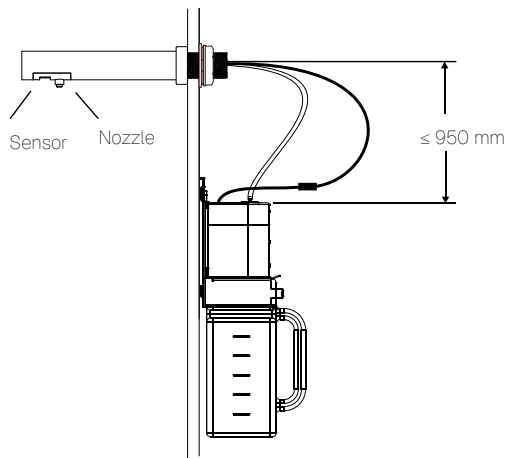

IMPORTANT!

- Ensure easy access to maintenance and cleaning of the unit
- It is recommended to install a power switch to the soap dispenser to ensure easy disconnection of the electricity supply before cleaning and maintenance
- Do not bend the hose too sharp. It can increase the resistance in the hose and reduce the ability of the pump to deliver a full dose
- Ensure unit is installed on solid and stable background
- Pay attention to the different properties of the different liquids, depending on the type of pump

PRODUCT APPLICATION

- Place your hands approx. 10-14 cm under the sensor to activate the dispenser. The dispenser will deliver 1-1.5 ml soap (0.6-0.8 ml foam)
- Remove hands after soap release
- Stops automatically when hands are moved away

LIGHT INDICATOR

Standby	Solid green light
Active	Pulsing light from green to red
Wrong type of soap/obstruction	Flashing green and red light
Empty soap reservoir*	Flashing green light

* The light indication for an empty soap container is based on a counter, which may vary depending on usage patterns and the container itself. Remove the soap container from the wall mount and reinsert it to reset the SoapTap unit.

CLEANING AND MAINTENANCE

We recommend performing inspection/cleaning and maintenance at least once a year, or as needed.

- Disconnect the power supply
- Remove dirt and debris
- Do not use running water, pressure washers, or similar equipment for cleaning
- Clean with a damp cloth and a mild soap solution. Never use abrasive cleaners or cleaning products with scouring/corrosive effects
- Clean the sensor with a damp cloth to remove dirt and debris, to prevent unintended activations
- Check for leaks around the control box, pump, hose, or container. Leaks can damage the control box
- Ensure the fork inside the control box makes a tilting movement when activated
- Check that the pump is moving the soap through the hose
- The pump and control box are wear parts. See expected service life under technical specifications

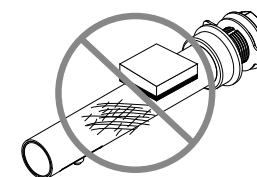
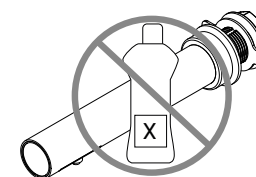
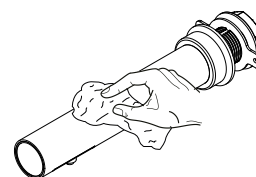

REFILL THE SOAP CONTAINER

- Remove the soap container and pump unit from the control box
- Lift the pump out of the soap container and refill the container
- Insert the pump into the refilled soap container, then mount the container and pump into the control box
- Note! Do not remove the soft hose from the pump



CALIBRATION OF SENSOR RANGE

- Cut the power
- Connect power to the dispenser
- Place your flat hand close to the sensor until the green light on the front of the tap turns off and starts flashing red
- Move your hand to the desired activation distance
- The calibration setup has completed with the new distance when it starts blinking green again

SCAN VIDEO



TROUBLESHOOTING AND CORRECTIVE ACTIONS

SYMPTOM	CORRECTIVE ACTION
The dispenser has stopped dispensing	Ensure power is on. Ensure the soap reservoir is installed properly in it's holder. Ensure the hose is not bent or twisted. Ensure the tubing is installed correctly and fits tightly. A broken hose will not fit tightly on the pompe, soap will be dripping and it will eventually damage the control box. Ensure exit nozzle, hose and pump are not clogged. Ensure that soap meets specified viscosity range: SOAPTAP 378/478 viscosity 1cP - 3000cP. FOAMTAP 382/482 viscosity 1cP.
Soap dispenser is malfunctioning	Check the IR-sensor works properly (see section for light indication p. 8). Clean sensor for dirt. Cut off power and reconnect to restart the system. You could try to calibrate the sensor range (see section for sensor calibration). If the problem persists, replace the sensor.
The soap dispenser sounds strained and it does not dispense a full dose	Ensure there are no bends, knots or kinks on the hose. Check if the nozzle, hose or pump is clogged. Ensure that soap meets specified viscosity range: SOAPTAP 378/478 viscosity: 1cP - 3000cP FOAMTAP 382/482 viscosity: 1cP
Flashing green light	Confirm the unit's reservoir is filled with soap. If soap reservoir is not empty, remove reservoir from wall bracket and place it back to reset light indicator for empty soap reservoir. Contact DAN DRYER for help, if nothing works.

PARTS LIST

No.	Description
1	TAP wall-mounted
2	End piece FOAM End piece SOAP
3	Holder for sensor and nozzle
4	Screw A2, M3x8
5	Washer
6	Large gasket
7	Nut
8	Complete insert (PCB, Sensor, Cable)
9	Hose/nozzle connector
10	Nozzle for FOAM
11	Nozzle for SOAP
12	Soap hose for SOAP/FOAM
13	Control box
14	Wall bracket for control box and soap container
15	Tool for tightening nut
16	Soap container 1.5 L Soap container 3.0 L
17	Pump FOAM
18	Pump SOAP
19	AC-adapter

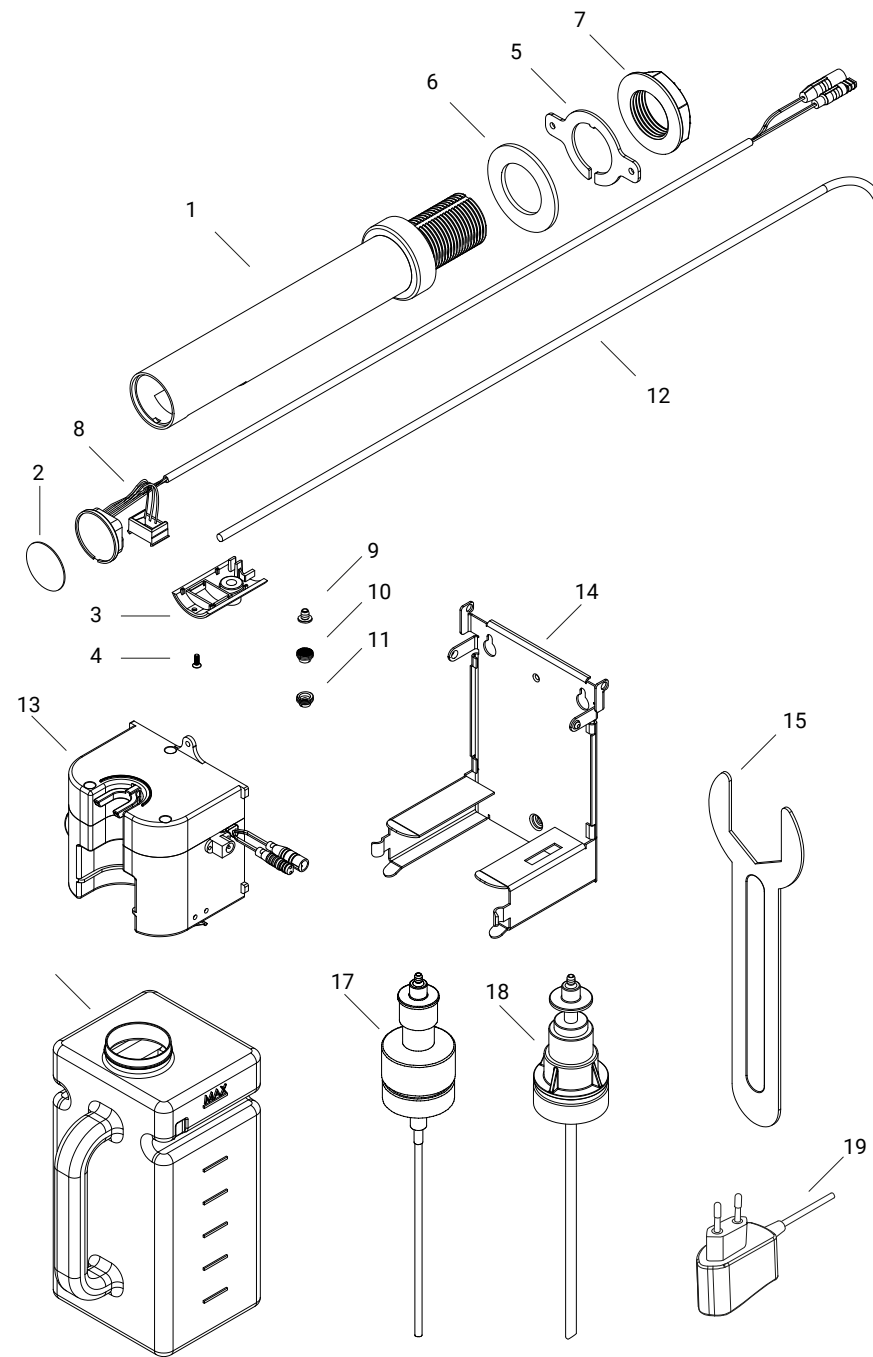

RESERVEDELSLISTE

Pos. nr.	Art. nr.	Spare part
1	51632	TAP SOAP wall-mounted
	51651	TAP FOAM wall-mounted
2	51659	End piece FOAM
	51637	End piece SOAP
3	51647	LED light panel
4	51648	Holder for LED light panel
5	51666	Sensor and nozzle silicone liner
6+7	51656	Sensor and holder for nozzle (lower part)
8	51660	Holder for sensor and nozzle (upper part)
9	51705	Bushing Ø 34 mm with thread
10	51706	Gasket for bushing
11	51697	Disc
12	51700	Gasket big
13	51696	Nut
15	51655	Nozzle for FOAM
16	51654	Nozzle for SOAP
18	51649	Soap tube FOAM, 100 cm
	51653	Soap tube LIQUID, 70 cm
19	51630	Control box
20	51641	Mounting plate for control box and soap container
22	51634	Soap container 1.5 L
	51643	Soap container 3 L
23	51650	Pump FOAM
24	51635	Pump SOAP
25	10888	AC-adapter



DAN DRYER A/S
Tåsingevej 2
DK - 8940 Randers SV

+45 8641 5711
info@dandryer.com
dandryer.com

