

BRUGERMANUAL

SOAPTAP

Wall mounted

Prod. no. 376/380/476/480/736/740



TABLE OF CONTENTS

Dimensions and technical specifications	3
General safety information	4
Installation	5
Installation height	8
Product application	8
Light indicator	8
Cleaning and maintenance	9
Refill of soap container	9
Calibration of sensor range	10
Troubleshooting and corrective actions	11
Parts list	12
Spare parts list	14

DIMENSIONS AND TECHNICAL SPECIFICATIONS

Dimensions

Unit of measurement: mm

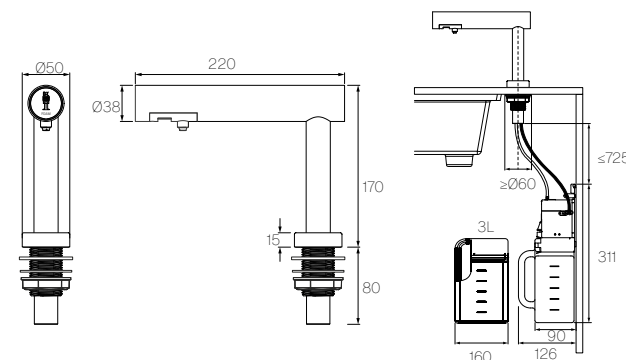

TECHNICAL SPECIFICATIONS

DESCRIPTION	DATA
Material	Stainless steel - AISI 304
Voltage	6V DC, AC/DC adapter is included
Stand-by power	0,3-0,4W
Sensor type	Infrared, self adjusting
Sensor range	20 mm - 150 mm. Standard 120 mm ± 20 mm, adjustable
Soap/foam dosing volume	1-1.5 ml (soap), 0.6-0.8 ml (foam)
Soap pump service life	100,000 activations
Mechanism service life	500,000 activations
Soap container	1,500 ml, optional 3000 ml
IP Class	IP35
Net weight	1,9 kg
Gross weight	2,3 kg
Model	376, Stainless steel, satin finish, SoapTap
	380, Stainless steel, satin finish, FoamTap
	476, Stainless steel, black PVD coating, SoapTap
	480, Stainless steel, black PVD coating, FoamTap
	736, Stainless steel, black PVD coating, SoapTap
	740, Stainless steel, black PVD coating, FoamTap

IMPORTANT!

This product falls within the scope of the WEEE directive on recycling and recovery of waste electrical and electronic equipment.



- This product should not be disposed of with general household waste.
- This product must be reused if possible.
- Contact your local authority for further details.
- This product may also be returned to the manufacturer/retailer for proper treatment, recovery and recycling.



GENEREL SIKKERHEDSINFORMATION

WARNING

- Disconnect the power supply to the unit before cleaning or servicing.
- No structural modifications may be made to the product. Any modifications will void DAN DRYER's warranty obligations. Exception: The soap hose may be shortened if necessary, as this improves the machine's ability to dispense soap efficiently.
- Regularly inspect the product for damage. A damaged product or a product that does not function correctly must not be used.
- Do not use accessories or spare parts that are not recommended by the manufacturer.
- Vandalism and misuse are not covered by DAN DRYER's warranty obligations.
- Do not insert any objects into the openings of the unit.
- Children must not play with the unit.
- Packaging elements (plastic bags, cardboard boxes, etc.) must be kept out of reach of children, as they pose a potential hazard.
- Children must not carry out cleaning or maintenance. Cleaning and maintenance may only be performed by adults who have been instructed in the safe use of the unit.
- The unit must only be used for its intended purpose. Any other use is considered improper and may be dangerous. The manufacturer accepts no liability for damage caused by incorrect or improper use.
- Ensure that the unit is completely dry before use.
- Never place the unit in locations where it may fall into water.
- Do not attempt to retrieve an electrical appliance that has fallen into water.
- If the power cable is damaged, it must be replaced immediately. Follow the manufacturer's instructions for removal and replacement of the supply cable.
- The unit may only be used by children over 8 years of age and by persons who have received the necessary instruction in safe use or are under the supervision of an adult. Persons with reduced physical or mental capabilities may only use the unit if they have been instructed in correct use and understand the risks involved.

INSTALLATION

Make sure the main breaker is turned off. Installation must be carried out by a qualified person in accordance with applicable standards in the country concerned.

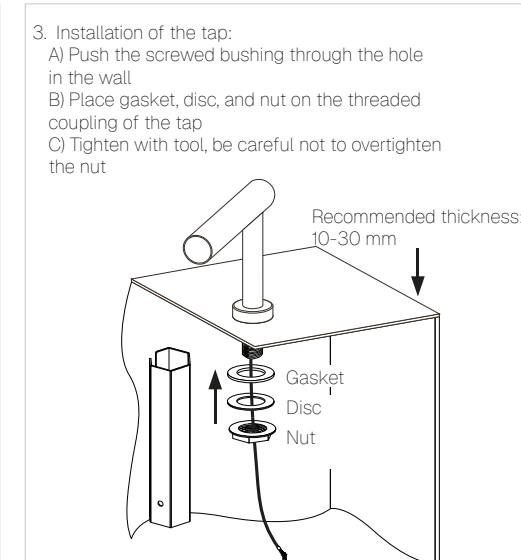
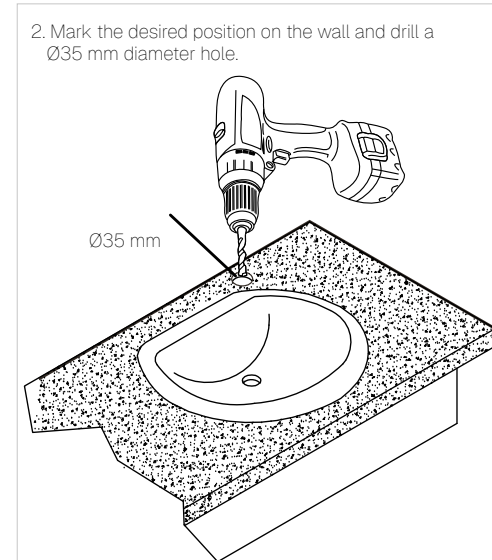
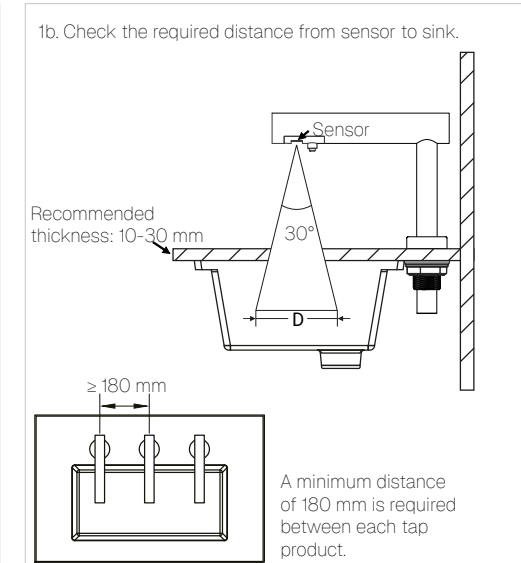
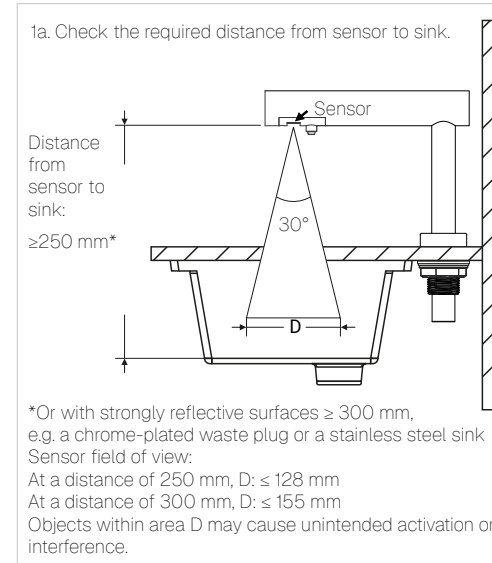

INSTALLATION

4. Use a template to drill the holes for the bracket. Install bracket close to Soap/Foam Tap; behind a wall, in a cabinet, or under the sink.

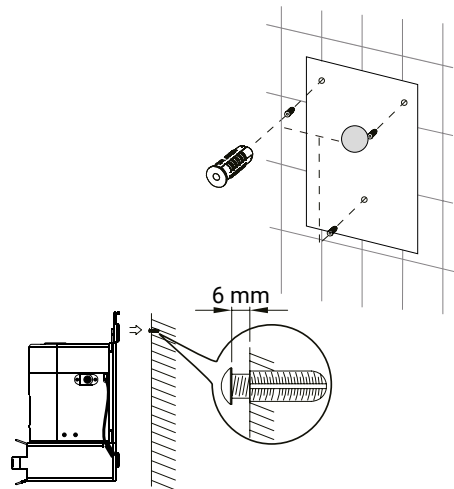

5. Fasten bracket into the pre-drilled holes.

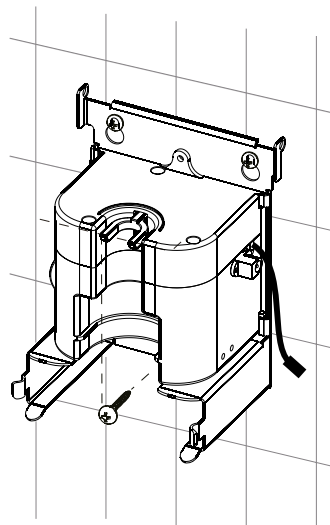

8. Insert soap container 1.5 or 3 L. Confirm the container is placed correctly to activate the dispenser. The fork should be on top of the disc at the pump top.

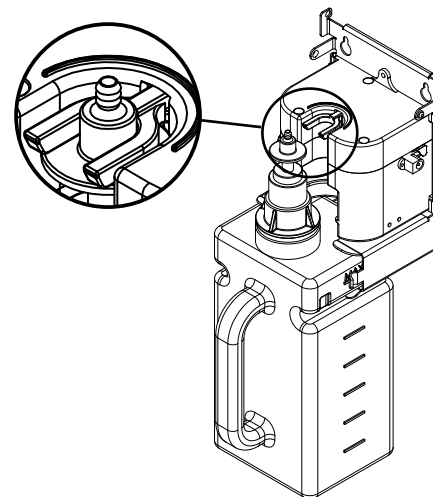

6. Connect the soft rubber tube to the outlet of the pump, and place the pump into the soap container.

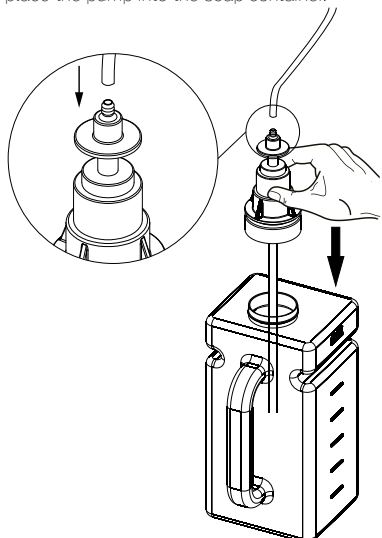

7. Connect the tube to the pump and the cables to the control box.

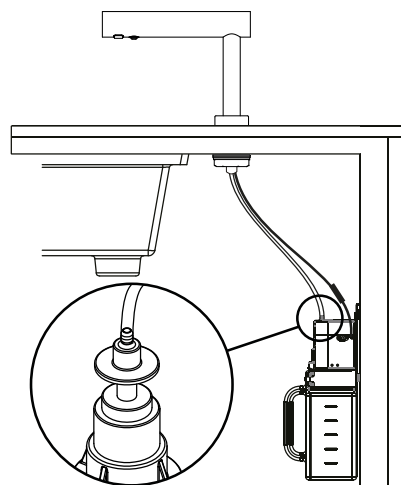

9. Connect 6 V DC power supply to control box.

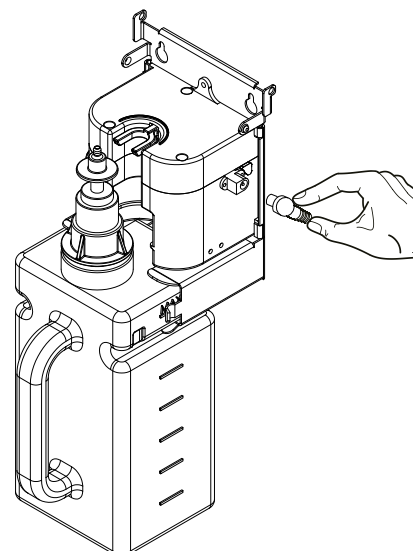

INSTALLATIONSHEIGHT

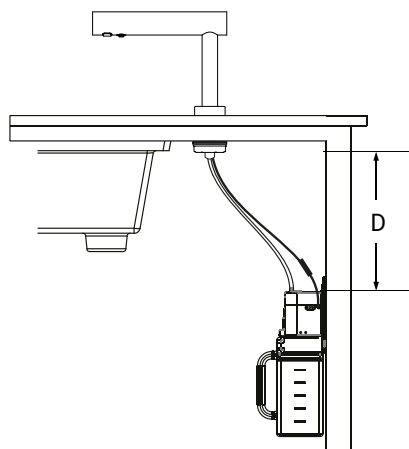

Soap: $D = \leq 215$ mm
 Foam: $D = \leq 425$ mm

Ensure easy access to maintenance and cleaning of the unit.

It is recommended to install a power switch to the soap dispenser to ensure easy disconnection of the electricity supply before cleaning and maintenance.

Do not bend the hose too sharp. It can increase the resistance in the hose and reduce the ability of the pump to deliver a full dose.

Ensure unit is installed on solid and stable background.

Pay attention to the different properties of the different liquids, depending on the type of pump.

PRODUCT APPLICATION

- Place your hands approx. 10-14 cm under the sensor to activate the dispenser. The dispenser will deliver 1-1.5 ml soap (0.6-0.8 ml foam)
- Remove hands after soap release
- Stops automatically when hands are moved away

LIGHT INDICATOR

Standby	Solid green light
Active	Pulsing light from green to red
Wrong type of soap/obstruction	Flashing green and red light
Empty soap reservoir*	Flashing green light

* Light indication for empty soap reservoir is based on a counter that resets when power is switched off, e.g. when refilling soap. The calculation is based on a 1.5 L soap reservoir and will call for soap refill every 1.2 L (approx. 1000 activations). If using foaming soap the empty reservoir indication flashes even though the reservoir is still half full. Remove reservoir from wall bracket and place it back to reset the SoapTap unit.

CLEANING AND MAINTENANCE

- We recommend carrying out regular inspection/cleaning and maintenance at least once a year, or as required
- Disconnect the electrical power supply
- Remove dirt and debris
- Do not use running water, a high-pressure cleaner, or similar equipment for cleaning
- Clean using a damp cloth with a mild soap solution. Never use abrasive cleaning agents or cleaning products with abrasive or corrosive effects
- Clean the sensor of dirt and debris with a damp cloth to avoid unintended activations
- Check for leaks around the control box at the pump, hose, and container. Leaks may cause damage to the control box
- Check that the fork in the control box performs a tilting movement when activated
- Check that the pump moves the soap through the hose
- The pump and control box are wear parts. See the expected service life under the technical specifications

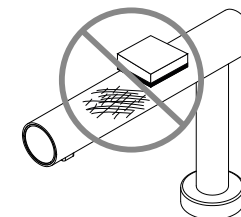
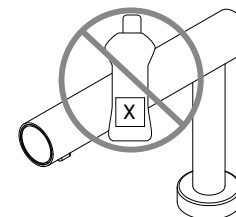
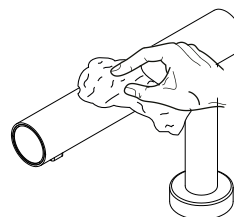

REFILL OF SOAP CONTAINER

- Remove the soap container and pump unit from the control box
- Lift the pump out of the soap container and refill the container
- Insert the pump into the filled soap container, and mount the soap container and pump back into the control box
- Note: Do not remove the soft hose from the pump



CALIBRATION OF SENSOR RANGE

Calibration is performed to set the sensor's activation distance.

- Cut the power
- Connect power to the dispenser
- Place your flat hand close to the sensor until the green light on the front of the tap turns off and starts flashing red.
- Move your hand to the desired activation distance
- The calibration setup has completed with the new distance when it starts blinking green again.

SCAN VIDEO



TROUBLESHOOTING AND CORRECTIVE ACTIONS

SYMPTOM	CORRECTIVE ACTION
The dispenser has stopped dispensing	Ensure power is on. Ensure the soap reservoir is installed properly in it's holder. Ensure the hose is not bent or twisted. Ensure the tubing is installed correctly and fits tightly. A broken hose will not fit tightly on the pumpe, soap will be dripping and it will eventually damage the control box. Ensure exit nozzle, hose and pump are not clogged. Ensure that soap meets specified viscosity range: SOAPTAP 376/476 viscosity 1cP - 3000cP. FOAMTAP 380/480 viscosity 1cP.
Soap dispenser is malfunctioning	Check the IR-sensor works properly (see section for light indication p. 8). Clean sensor for dirt. Cut off power and reconnect to restart the system. You could try to calibrate the sensor range (see section for sensor calibration). If the problem persists, replace the sensor.
The soap dispenser sounds strained and it does not dispense a full dose	Ensure there are no bends, knots or kinks on the hose. Check if the nozzle, hose or pump is clogged. Ensure that soap meets specified viscosity range: SOAPTAP 376/476 viscosity: 1cP - 3000cP FOAMTAP 380/480 viscosity: 1cP
Flashing green light	Confirm the unit's reservoir is filled with soap. If soap reservoir is not empty, remove reservoir from wall bracket and place it back to reset light indicator for empty soap reservoir.

PARTS LIST

No.	Description
1	TAP wall-mounted
2	End piece FOAM End piece SOAP
3	Holder for sensor and nozzle
4	Screw A2, M3x8
5	Washer
6	Large gasket
7	Nut
8	Complete insert (PCB, Sensor, Cable)
9	Hose/nozzle connector
10	Nozzle for FOAM
11	Nozzle for SOAP
12	Soap hose for SOAP/FOAM
13	Control box
14	Wall bracket for control box and soap container
15	Tool for tightening nut
16	Soap container 1.5 L Soap container 3.0 L
17	Pump FOAM
18	Pump SOAP
19	AC-adapter

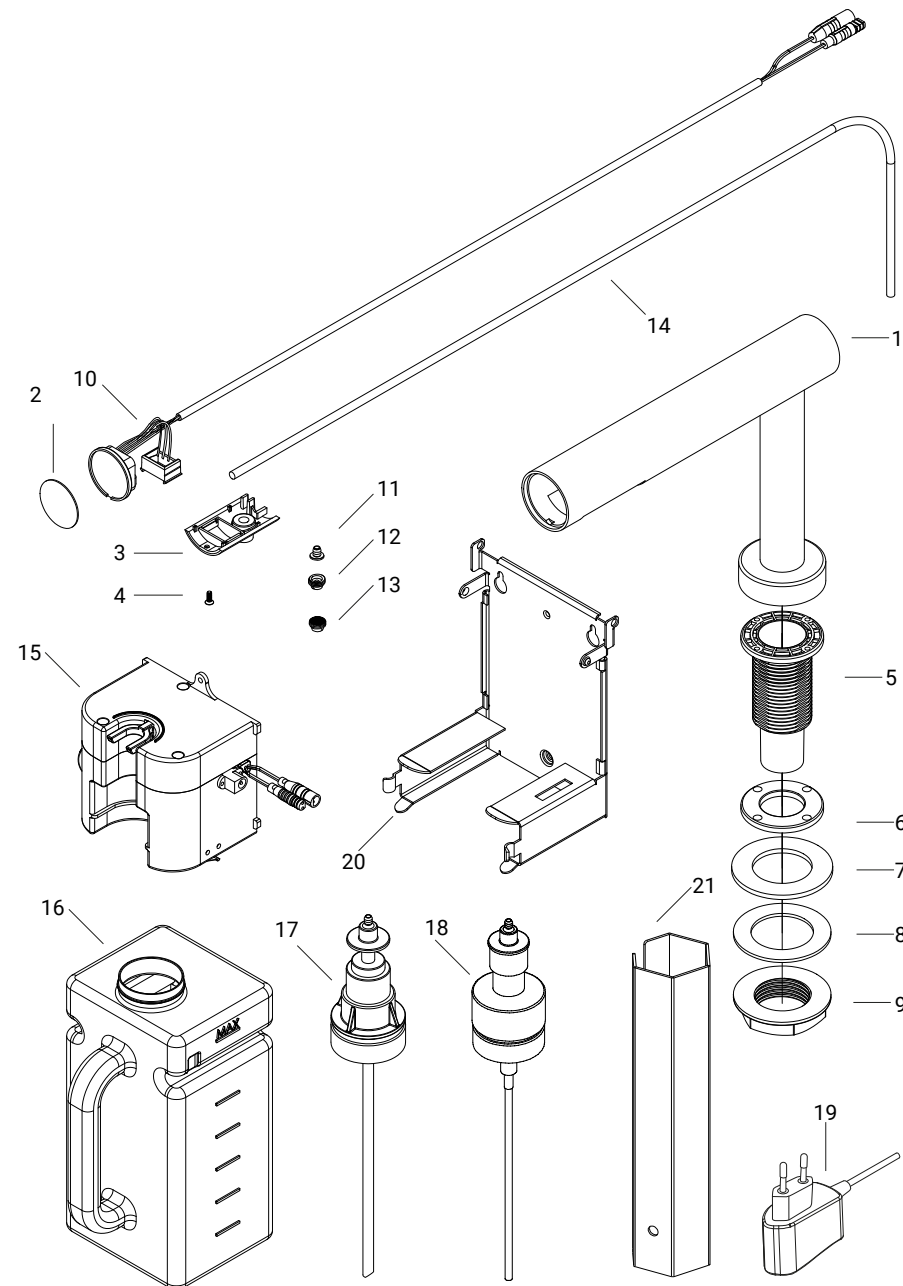

SPARE PARTS LIST

Pos. nr.	Art. nr.	Spare part
1	51632	TAP SOAP wall-mounted
	51651	TAP FOAM wall-mounted
2	51659	End piece FOAM
	51637	End piece SOAP
3	51647	LED light panel
4	51648	Holder for LED light panel
5	51666	Sensor and nozzle silicone liner
6+7	51656	Sensor and holder for nozzle (lower part)
8	51660	Holder for sensor and nozzle (upper part)
9	51705	Bushing Ø 34 mm with thread
10	51706	Gasket for bushing
11	51697	Disc
12	51700	Gasket big
13	51696	Nut
15	51655	Nozzle for FOAM
16	51654	Nozzle for SOAP
18	51649	Soap tube FOAM, 100 cm
	51653	Soap tube LIQUID, 70 cm
19	51630	Control box
20	51641	Mounting plate for control box and soap container
22	51634	Soap container 1.5 L
	51643	Soap container 3 L
23	51650	Pump FOAM
24	51635	Pump SOAP
25	10888	AC-adapter



DAN DRYER A/S
Tåsingevej 2
DK - 8940 Randers SV

+45 8641 5711
info@dandryer.com
dandryer.com

